

G|C  
GOLD COAST  
ESTATE  
SIBAYA

HOME TYPE 5  
PACIFICA

Sibaya Coastal Precinct embodies the live-work-play philosophy as a mixed-use and residential space. Spanning over 1000 hectares with 60% green coastal forest and rehabilitated landscapes, Sibaya Coastal Precinct encompasses 6.5km of pristine beaches and 75km of paths, trails and boardwalks. Central to the precinct is the Heleza Boulevard thoroughfare aimed at connecting the community to a myriad of retail and commercial options through its central location.

The Gold Coast Estate presents an exceptional residential offering within Sibaya Coastal Precinct. Through its exclusive design, Gold Coast Estate offers aesthetically-elegant freehold homes optimized for energy-efficiency and geared for green living. With family and community at its core, amenities abound in this secure estate designed to accommodate the facets of work, leisure and family-life.

---

## HOME TYPE 5 PACIFICA

---

With 5-bedrooms, Pacifica is a split-level home with the top level containing a formal lounge. Each en-suite bedroom enjoys privacy with the coastal forest backdrop, whilst the entertainment area enjoys magnificent oceanic views.





The depictions herein are for illustration purposes only and are subject to change without prior notice.



# 3D FLOOR PLANS

## HOME TYPE 5 PACIFICA

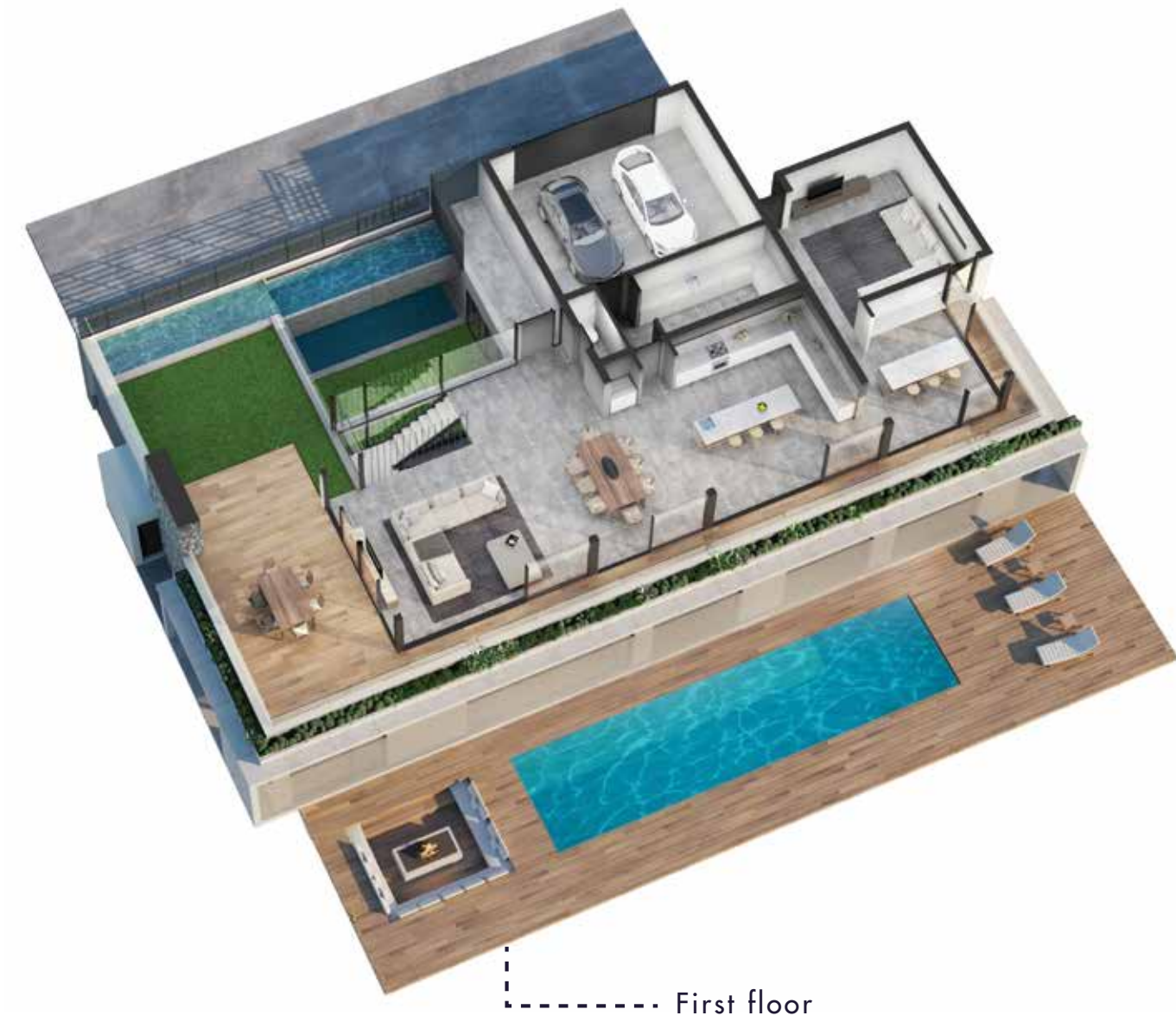
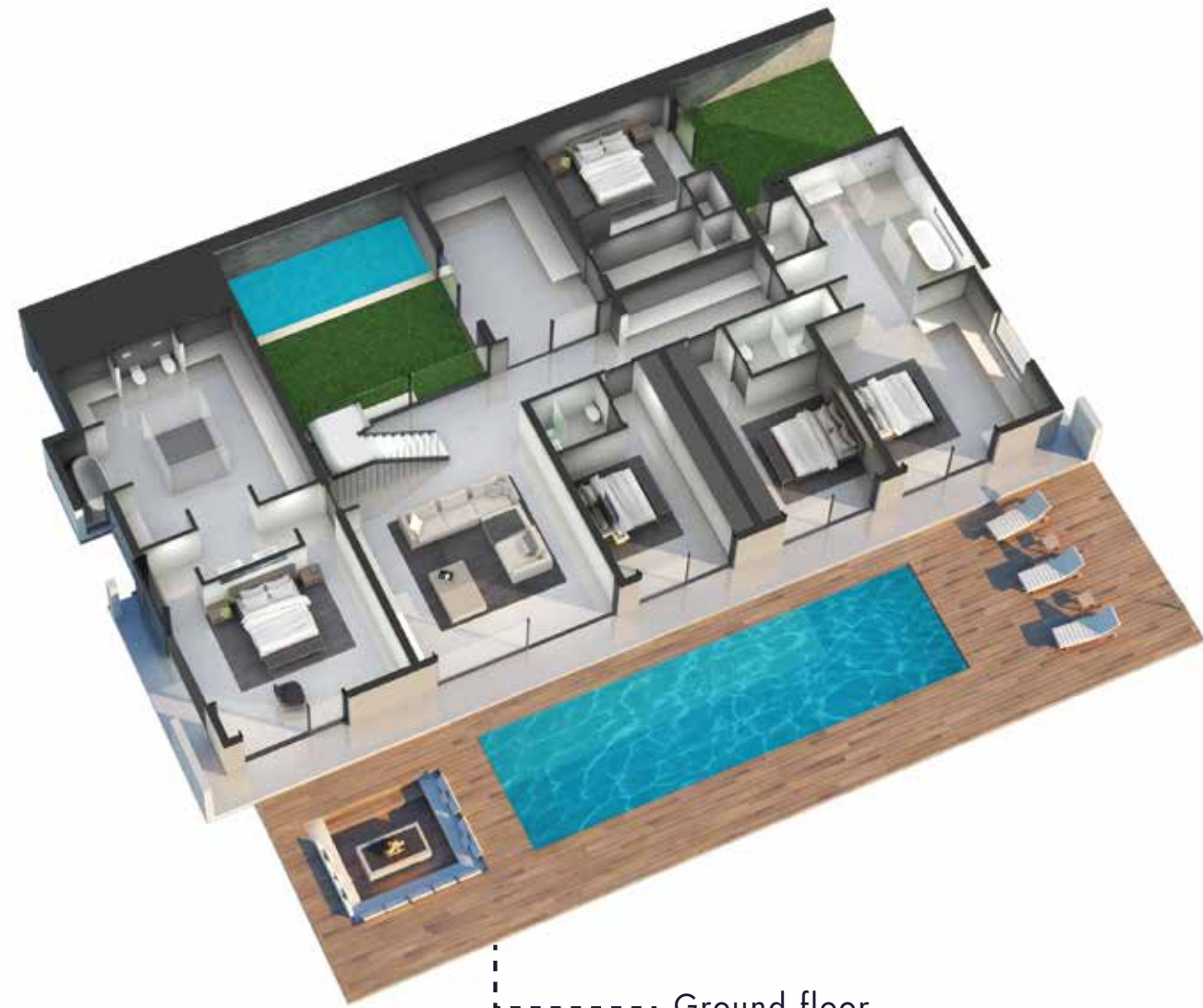

# FLOOR PLANS

Home type 5 / Pacifica

## UNIT 5

5 Bedroom, 6 Bathroom

Ground floor	298.51
First floor	162.80
Garage	34.64
Covered patio	100.63

596.58m<sup>2</sup>



*This is living*



087 095 2741